

**Lbs System Joint to connect
suspension perimetric emission to
suspension direct-diffused emission**

code LB427



PRODUCT DESCRIPTION

PRODUCT SPECS

Installation method	system
Dimension	mm

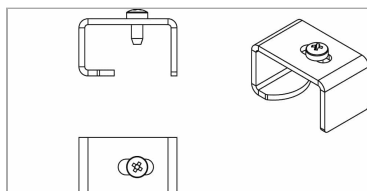

WEB PAGE



**ASSEMBLY
INSTRUCTIONS**



Complies with EN605981 and related notes. In the absence of metric symbols, the measurements are all in mm.
Luminous flux and power data are initially subject to tolerances +/- 10%. The values refer to an ambient temperature of 25 °C unless otherwise specified.
We reserve the right to make changes to our products at any time.